



LANVR TOOLINGS

info@lanvrtoolings.com • Lokam@lanvrtoolings.com





Iron Worker



Self Stripping



Scotch Man



PUNCHES & DIES OPTIONS

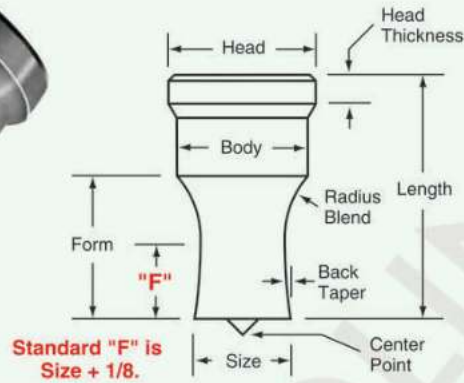

EXTRA LENGTH PUNCHES

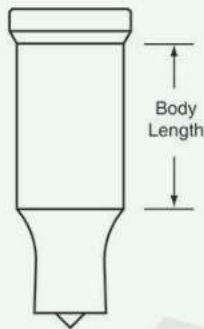

Added length to body

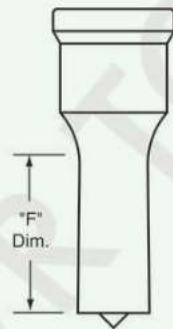

Added length to "F" or the working length

DOUBLE BODY FOR PUNCHING LEG UP

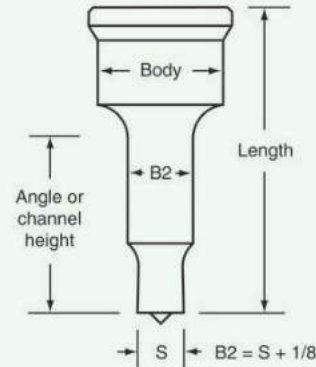

SHEAR FACE



V-Shear

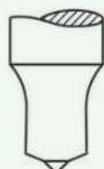

V-Shear with Center Point

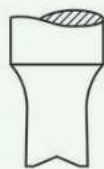

Y-Shear

KEYWAYS



"V" Groove Round Key Stock

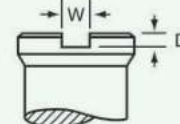

Standard



Side Head

Keyways are standard for some machines. Please advise machine make when ordering.

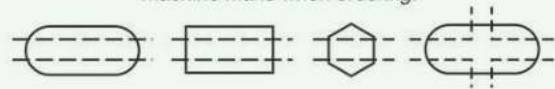

Standard Keyway Position



PUNCHES & DIES OPTIONS

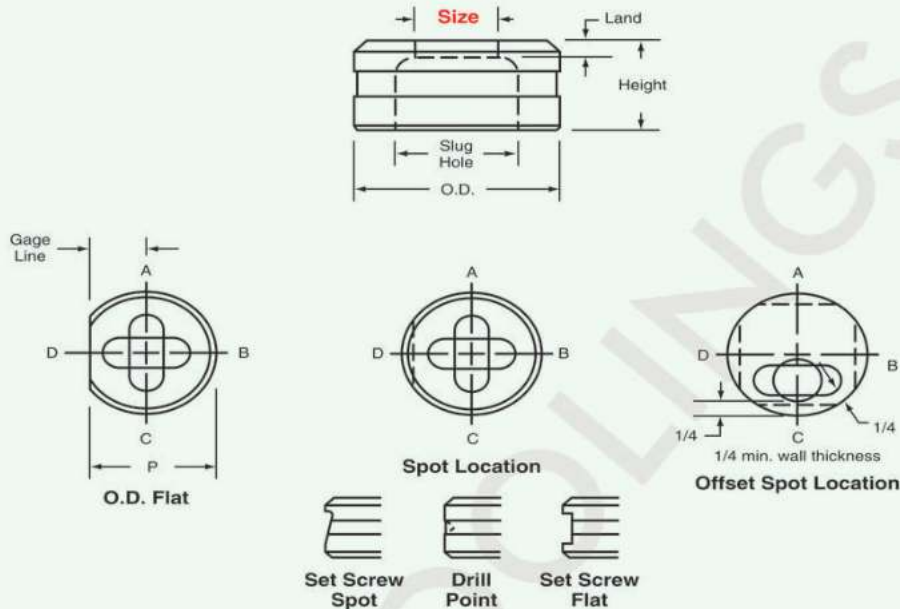

STANDARD SHAPES

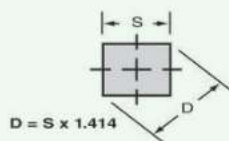
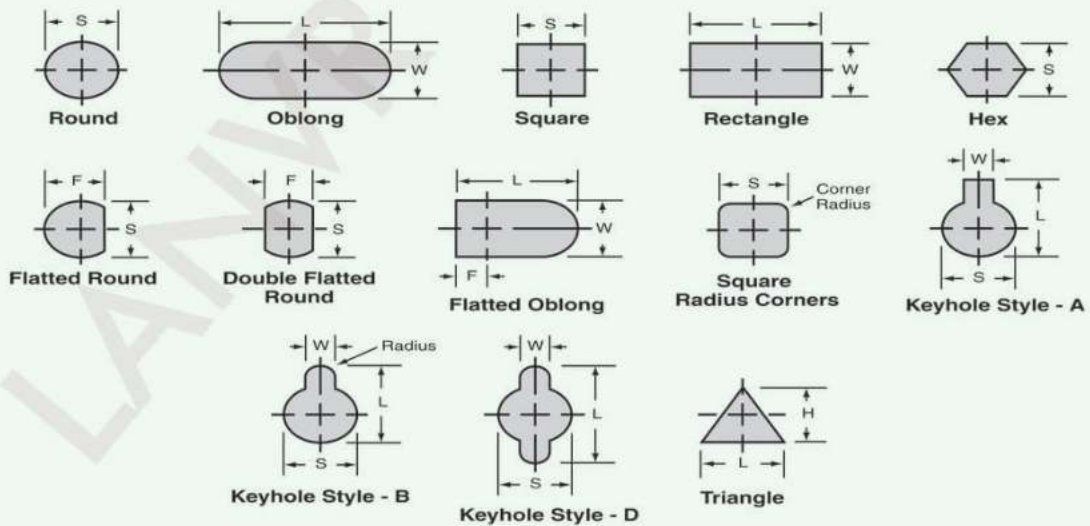

Squares and rectangles "D" dimension is larger than the "S" dimension of the square and larger than the "L" dimension of the rectangle. The "D" dimension must not exceed the body diameter of the punch or the bore diameter of the coupling nut. Check with your salesperson for possible modifications to accommodate oversize tools.

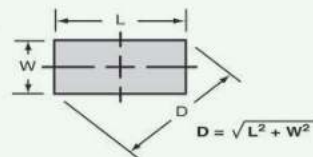



COPERS NOTCHER BAR CUTTERS & SHEAR BLADES

BAR CUTTER



NOTCHER PUNCH

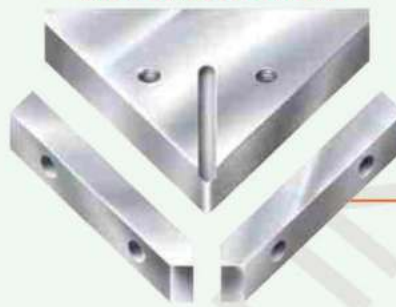

NOTCHER DIES

ANGLE BLADES



COPER PUNCH



COPER DIES

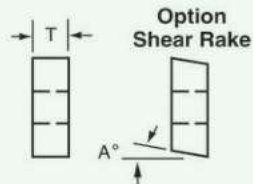
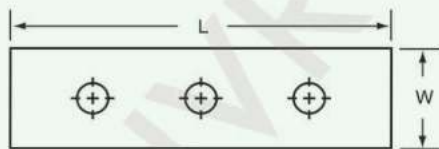

Cap Screw
Countersink

Straight-thru
Hole

Tapped

Single End
Countersink

Double End
Countersink
With or Without
Keyway

Double End
Countersink
With
Counterbore

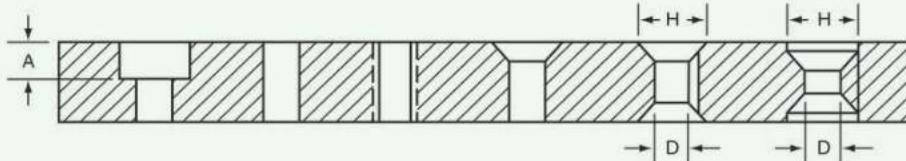
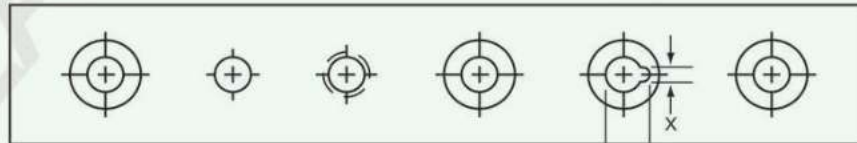



Sheet Cutting Blade

Product Details:

Automatic Grade	Automatic, Semi-Automatic, Manual
Max Shear Thickness	1-2 mm , 2-3 mm , 3-4 mm , 4-5 mm , 5-6 mm , >6 mm
Material to be Sheared	Copper, Stainless Steel, Iron, Aluminum, Carbon Steel, Mild Steel
Max Shear Width	0-500 mm, 500-1000 mm, 1000-2000 mm, 2000-3000 mm, 3000-4000 mm, >4000

Automatic Grade Automatic, Semi-Automatic ,Manual

Material to be Sheared Copper ,Stainless Steel ,Iron ,Aluminum .
Carbon Steel

Max Shear Thickness 1-2 mm, 2-3 mm , 3-4 mm ,4-5 mm ,5-6 mm .
>6 n-) m

Max Shear Width 0-500 mm, 500-1000 mm, 1000-2000 mm,
2000-3000 mm ,3000-4000 mm ,>4000



Forming Rollers



Slitters



KNIVES FOR HOT MILLS



- Slab Shear Knives
- Rotary Drum Knives
- Straight Crop Knives
- Hot Crop Knives
- Pendulum Shear Knives
- Side Trimmers

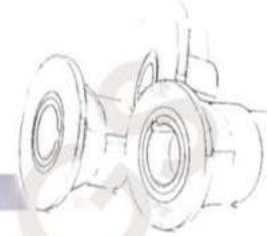

ROLLS & KNIVES FOR COLD ROLLING MILLS



- Work Rolls
- Backup Rolls
- Intermediate Rolls
- Cut-to-Length Knives
- Profile Shear Blades

ROLLS & KNIVES FOR PIPE & TUBE MILLS



- Forming Rolls for Production of Welded Tubes
- Forming Rolls for Open Profile
- Slitter Line Tooling
- Cut-to-Length Knives

KNIVES FOR STEEL SERVICE CENTERS



- Slitting Knives
- Rubber/ Polyurethane Bonded Spacers
- Spacers
- Shear Blades
- Separator Disks
- Leveller Rolls

KNIVES FOR NON-FEROUS INDUSTRY

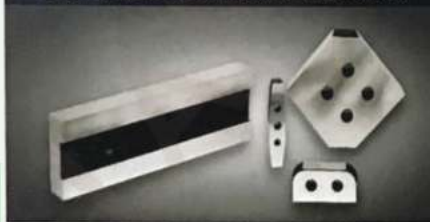

- Slitting Knives
- Rubber/ Polyurethane Bonded Spacers
- Spacers
- Shear Blades
- Separator Disks
- Leveller Rolls

KNIVES FOR METAL SCRAP RECYCLING & DEMOLITION

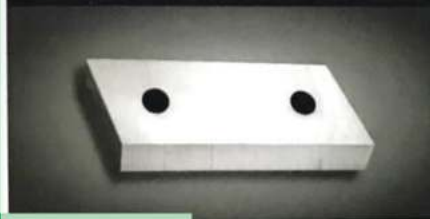

- Alligator Shears
- Stationary Shears
- Mobile Shears
- Balers
- Waste Recycling Shears



TYPE OF FLANGES



PIPE FLANGES



BLIND FLANGES



WELDING NECK FLANGES



SLIP ON FLANGES



SOCKET WELD FLANGES



THREADED FLANGES



LAP JOINT FLANGES



WELDED FLANGES



PLATE FLANGE



SCREWED FLANGES



REDUCING FLANGES



DIN FLANGES



ANSI FLANGES



FORGED STEEL FLANGES



METAL FLANGES



LONG WELD NECK FLANGES



RING JOINT FLANGES



WELDING FLANGES



ASME FLANGE



STEEL LAP JOINT FLANGES



ASTM FLANGES



PN FLANGES



PUDDLE FLANGES



ROUND FLANGE



SPLIT FLANGE



CAST FLANGES



ORIFICE FLANGE ASSEMBLY



PTFE LINED REDUCING FLANGE



SO FLANGE



FLANGE CONNECTOR

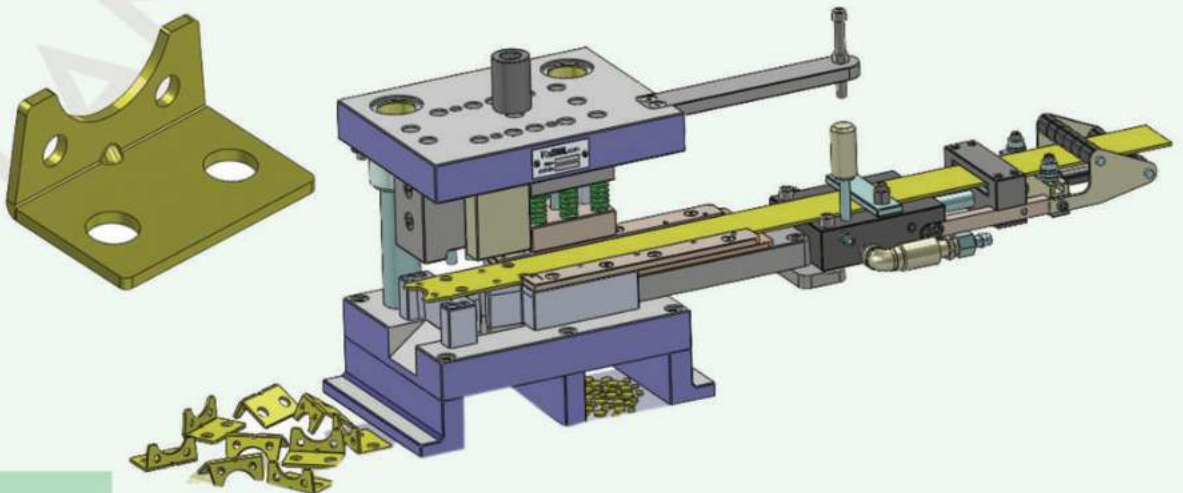
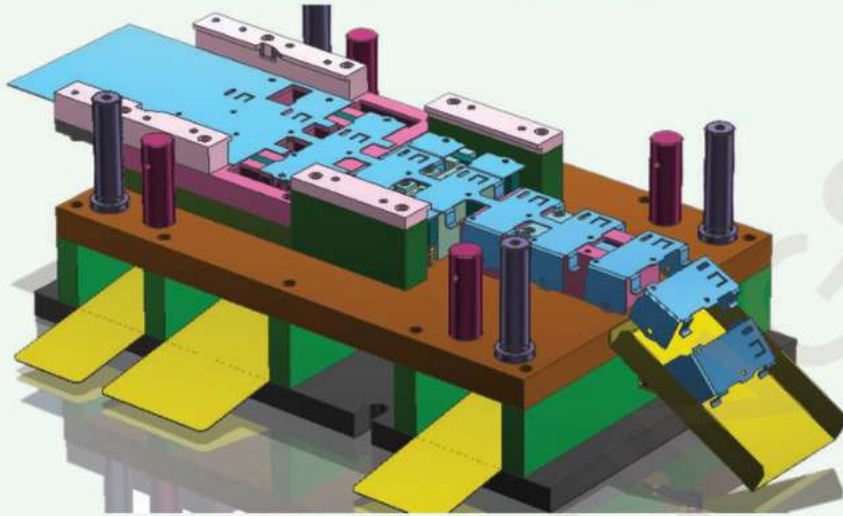



10

Hole Punches



Raw Material:
High Speed Steel
Shank:
HRC 64±2
Head: 45±2
Surface Finish:
0.3 - 0.4 µm

Piercing Punches - Type - D DIN - 9861

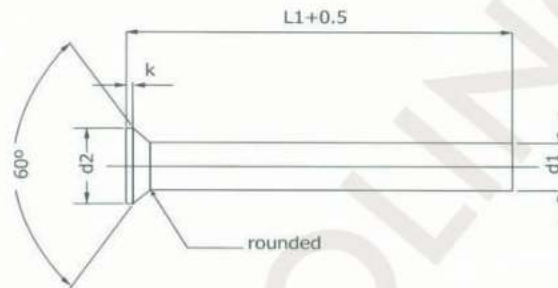

d1	h6	d2	k +0.2	d1	h6	d2	k +0.2
0.5	-0.007	0.9	0.2	3.1 to 3.4	-0.008	4.5	0.5
0.55		1.0		3.5 to 3.9		5.0	
0.6		1.1		4.0 to 4.4		5.5	
0.65		1.2	4.5 to 4.9	6.0			
0.7 & 0.75		1.3	5.0 to 5.4	6.5			
0.8 & 0.85		1.4	5.5 to 5.9	7.0			
0.9 & 0.95		1.6	6.0 to 6.4	8.0			
1.0 & 1.1		1.8	6.5 to 7.0	9.0			
1.2 & 1.3		2.0	7.5 to 8.0	10.0			
1.4 & 1.5		2.2	8.5 to 9.0	11.0			
1.6 & 1.7		2.5	9.5 to 10.0	12.0			
1.8 & 1.9		2.8	10.5 to 11.0	13.0			
2.0		3.0	11.5 to 12.0	14.0			
2.1 to 2.2		3.2	12.5 to 13.0	15.0			
2.3 to 2.5		3.5	13.5 to 14.0	16.0			
2.6 to 2.9		4.0	14.5 to 15.0	17.0			
3.0	4.5	15.5 to 16.0	18.0				
				16.5 to 17.0	-0.011	19.0	1.5

Finish: Hardened, Tempered & Precision Plunge Ground & Lapped

Diameter d1: All the above mentioned diameters d1 are in step of 0.05 mm upto Ø0.95mm and in step of 0.1 mm from Ø1.0 mm to Ø16.0 mm

Lengths L1: Lengths are 50, 70, 80 & 100 mm

Any other diameter and length available as per customers requirement

Ordering Example: d1*L1 = Quantity
10*70 = 20 pieces



JIS Standard Springs



General idea about the sizes

	Type	Code	Color	Outer Dia.		Free Length	
				min.	max.	min.	max.
Coil Spring		VJF	Yellow	Ø6 (Ø3)	Ø70	10	500
		VJL	Blue	Ø6 (Ø3)	Ø70	10	500
		VJM	Red	Ø6 (Ø3)	Ø70	10	350
		VJH	Green	Ø6 (Ø3)	Ø70	10	350
		VJB	Brown	Ø6 (Ø3)	Ø70	10	350
		VJG	Gray	Ø10 (Ø5)	Ø50	15	300
		VJU	Light Blue	Ø10.5	Ø43	15	300
		VJR	White	Ø10.5	Ø46	15	300
		VJY	Purple	Ø10.5	Ø46	15	300



SECTION: PRESS TOOL ACCESSORIES





LANVR TOOLINGS
info@lanvrtoolings.com • Lokam@lanvrtoolings.com



PRESS BRAKE TOOLS

**FAST CLAMPING SYSTEMS, ADAPTERS,
SERVICE/MODIFICATION,
ACCESSORIES, SHEAR BLADES**

14

WWW.LANVRTOOLINGS.COM

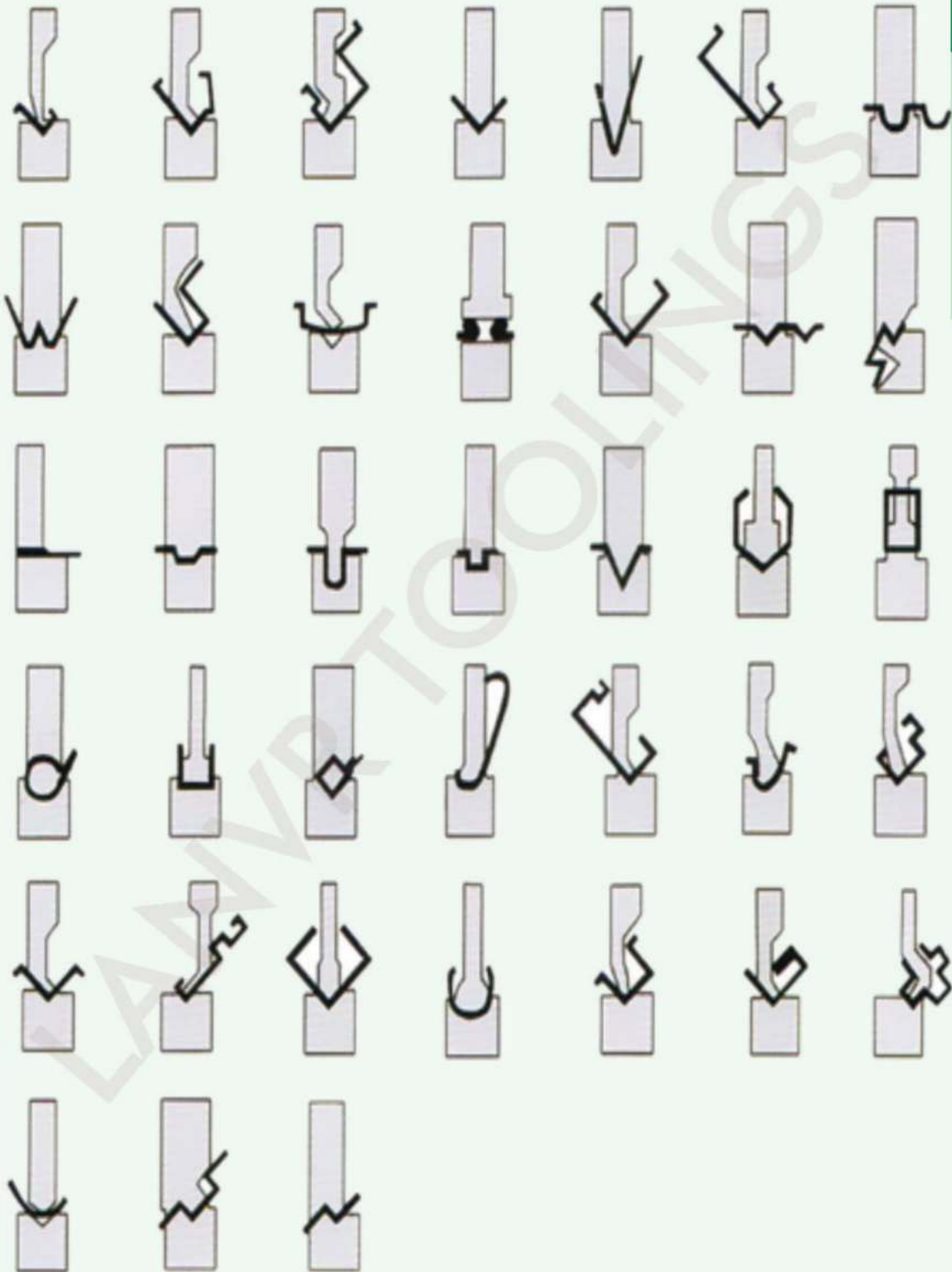



PK.97.90.R06 / P.97.90.R025

350 kN/m max.

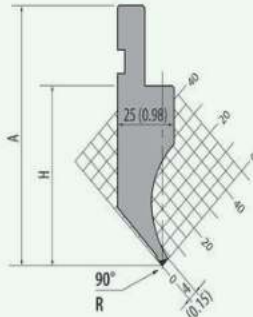

PK.97.90.R06		
H=66.80 / A=96.80 / R=0.6 (H=2.63 / A=3.81 / R=0.024)		
835 mm	32.87 in	10.5 kg
415 mm	16.34 in	5.2 kg
795 mm segmented	31.29 in segmented	10.0 kg
805 mm segmented	31.69 in segmented	10.1 kg
P.97.90.R025		
H=66.80 / A=96.80 / R=0.25 (H=2.63 / A=3.81 / R=0.010)		
835 mm	32.87 in	10.5 kg
415 mm	16.34 in	5.2 kg
795 mm segmented	31.29 in segmented	10.0 kg
805 mm segmented	31.69 in segmented	10.1 kg

42Cr-900-1150 N/mm² HORN 1

PK.97.90.R08 / R025

1000 kN/m max.

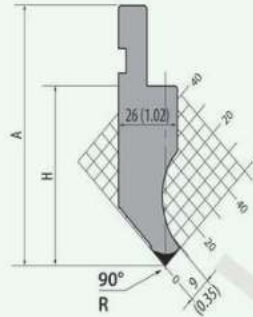

PK.97.90.R08		
H=66.35 / A=96.35 / R=0.8 (H=2.61 / A=3.79 / R=0.031)		
835 mm	32.87 in	11.0 kg
415 mm	16.34 in	5.5 kg
795 mm segmented	31.29 in segmented	10.5 kg
805 mm segmented	31.69 in segmented	10.5 kg
P.97.90.R025		
H=66.60 / A=96.60 / R=0.25 (H=2.62 / A=3.80 / R=0.010)		
835 mm	32.87 in	11.0 kg
415 mm	16.34 in	5.5 kg
795 mm segmented	31.29 in segmented	10.5 kg
805 mm segmented	31.69 in segmented	10.5 kg

C45: 560-710 N/mm² HORN 1

PK.114.90.R06

200 kN/m max.

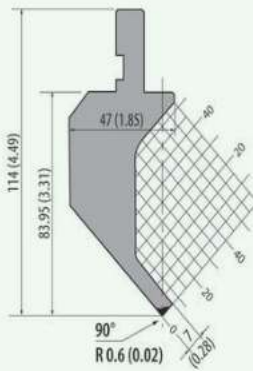

835 mm	32.87 in	14.0 kg
415 mm	16.34 in	7.0 kg
795 mm segmented	31.29 in segmented	13.3 kg
805 mm segmented	31.69 in segmented	13.5 kg

42Cr-900-1150 N/mm² HORN 1

PK.116.90.R08

400 kN/m max.

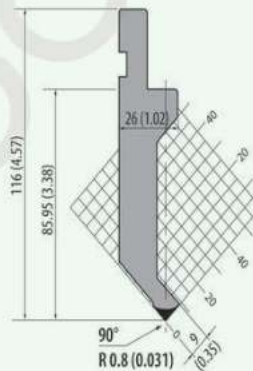

835 mm	32.87 in	13.0 kg
415 mm	16.34 in	6.5 kg
795 mm segmented	31.29 in segmented	12.4 kg
805 mm segmented	31.69 in segmented	12.5 kg

C45: 560-710 N/mm² HORN 1

DK.116.90.R08

500 kN/m max.

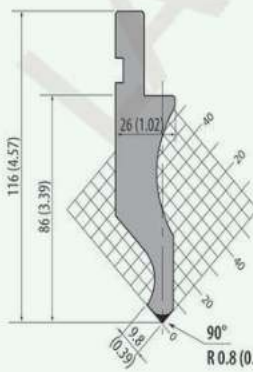

835 mm	32.87 in	13.0 kg
415 mm	16.34 in	6.5 kg
795 mm segmented	31.29 in segmented	12.4 kg
805 mm segmented	31.69 in segmented	12.4 kg

C45: 560-710 N/mm² HORN 1

PK.120.90.R08 / R025

600 kN/m max.

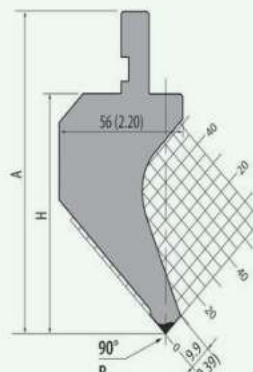

PK.120.90.R08		
H=89.35 / A=119.35 / R=0.8 (H=3.52 / A=4.70 / R=0.031)		
835 mm	32.87 in	21.0 kg
415 mm	16.34 in	10.5 kg
795 mm segmented	31.29 in segmented	20.0 kg
805 mm segmented	31.69 in segmented	20.2 kg
P.120.90.R025		
H=89.60 / A=119.60 / R=0.25 (H=3.53 / A=4.71 / R=0.010)		
835 mm	32.87 in	21.0 kg
415 mm	16.34 in	10.5 kg
795 mm segmented	31.29 in segmented	20.0 kg
805 mm segmented	31.69 in segmented	20.2 kg



According to the different machine brands,
there are several clamping Joints,
Please tell us which one from below:

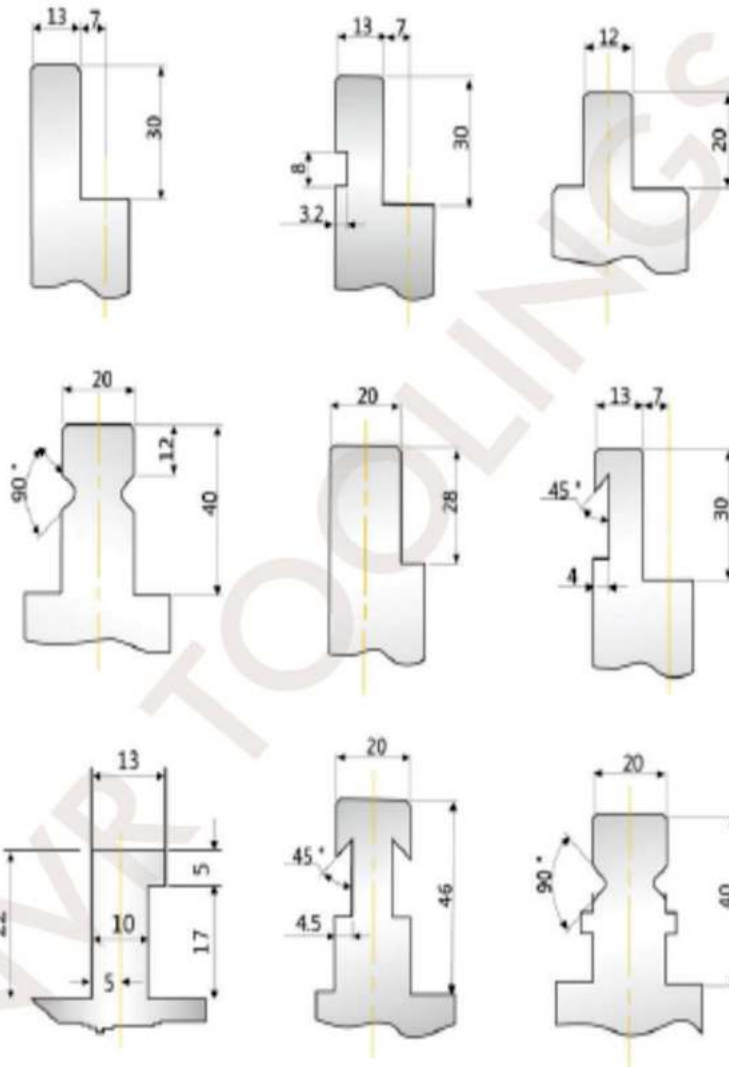

Also tell us below information:

a. The bending parts drawing (Bend Radius Internal and external contrast dimensions and tolerance range. etc.,)

B The thickness and material of the Sheet metal;

C. Requirements for indentation and scratch

d. The information of your press brake machine (Max. pressure workable length and clamp system for Punch & Die. etc...)

e. Other requirements.



M60.90.01

1000 kN/m max.

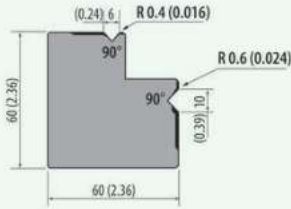

835 mm	32.87 in	20.0 kg
415 mm	16.34 in	10.0 kg
795 mm segmented	31.29 in segmented	19.0 kg
805 mm segmented	31.69 in segmented	19.3 kg

C45: 560-710 N/mm²

M60.90.02

800 kN/m max.

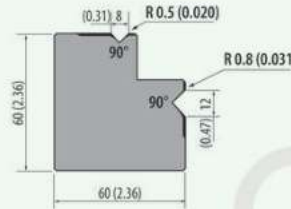

835 mm	32.87 in	21.0 kg
415 mm	16.34 in	10.0 kg
795 mm segmented	31.29 in segmented	20.0 kg
805 mm segmented	31.69 in segmented	20.2 kg

C45: 560-710 N/mm²

M.360.R

1000 kN/m max.

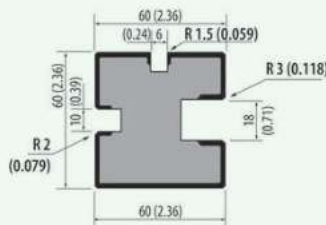

835 mm	32.87 in	20.0 kg
415 mm	16.34 in	10.0 kg
795 mm segmented	31.29 in segmented	19.0 kg
805 mm segmented	31.69 in segmented	19.3 kg

C45: 560-710 N/mm²

M.460.R

800 kN/m max.

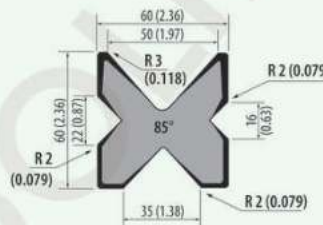

835 mm	32.87 in	15.7 kg
415 mm	16.34 in	7.7 kg
795 mm segmented	31.29 in segmented	14.9 kg
805 mm segmented	31.69 in segmented	15.1 kg

C45: 560-710 N/mm²

M.460

800 kN/m max.

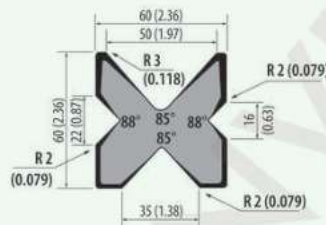

835 mm	32.87 in	15.8 kg
415 mm	16.34 in	7.8 kg
795 mm segmented	31.29 in segmented	15.0 kg
805 mm segmented	31.69 in segmented	15.2 kg

C45: 560-710 N/mm²

M.460.60

600 kN/m max.

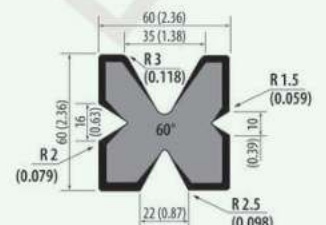

835 mm	32.87 in	18.0 kg
415 mm	16.34 in	9.0 kg
795 mm segmented	31.29 in segmented	17.1 kg
805 mm segmented	31.69 in segmented	17.3 kg

C45: 560-710 N/mm²





S101.35.06

600 kN/m max.

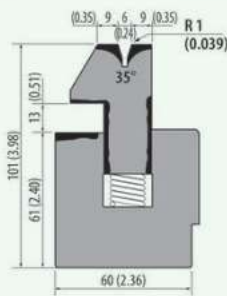

835 mm	32.87 in	30.0 kg
415 mm	16.34 in	15.4 kg

C45: 800-850 N/mm²

S101.35.08

600 kN/m max.

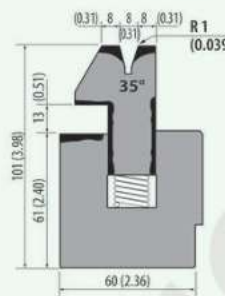

835 mm	32.87 in	30.0 kg
415 mm	16.34 in	15.0 kg

C45: 800-850 N/mm²

S101.35.10

600 kN/m max.

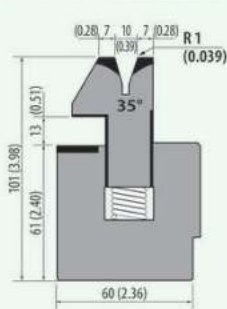

835 mm	32.87 in	30.0 kg
415 mm	16.34 in	15.5 kg

C45: 800-850 N/mm²

S110.30.08

800 kN/m max.

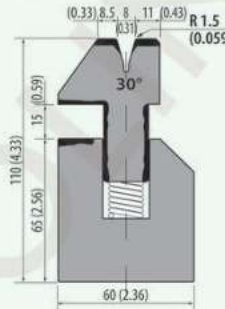

835 mm	32.87 in	30.0 kg
415 mm	16.34 in	15.0 kg

C45: 800-850 N/mm²

S135.26.08

400 kN/m max.

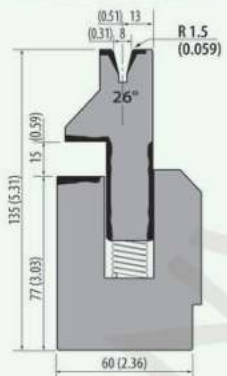

835 mm	32.87 in	39.8 kg
415 mm	16.34 in	21.0 kg

42Cr: 900-1150 N/mm²

S135.26.10

1000 kN/m max.

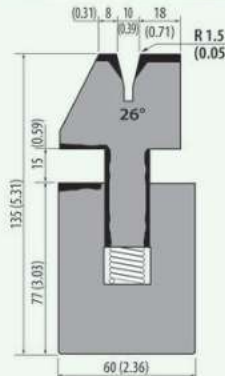

835 mm	32.87 in	41.5 kg
415 mm	16.34 in	20.7 kg

C45: 800-850 N/mm²

SA135.26.12

1000 kN/m max.

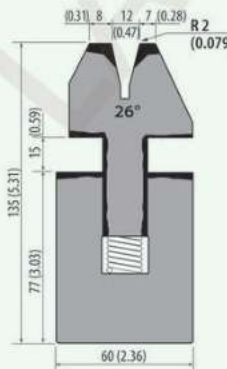

835 mm	32.87 in	41.0 kg
415 mm	16.34 in	20.5 kg

C45: 800-850 N/mm²

Our Advantage – Your Convenience

hemming dies can also be used as standard dies. You only have to secure the screws when the die is closed to prevent springs from moving the mobile part upwards.

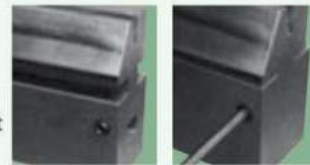



STANDARD MOULD BASE



Standard Mould Base ready in stock

- Raw material: S50C
- Sizes available from:
150 mm x 150 mm to 400 mm x 400 mm
- Various options available for core & cavity plate thickness
- Standard mould base fitted with standard mould components (guide pin bush, return pin)



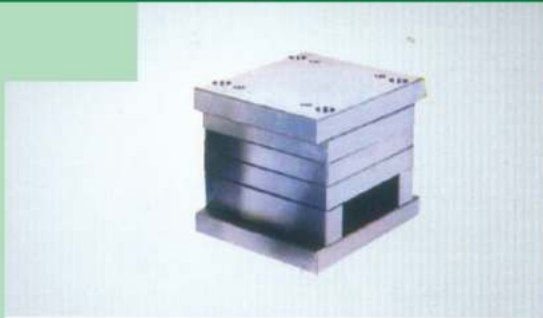

Mould Base

INTRODUCTION

- Standard Mould Bases: are imported from world leading Companies
- Basic 2 Plate standard Mould Bases are imported and stored in ware house in order to provide fastest delivery to customers
- **To explore the possibility of using standard Mould Base customers can ask 3D or 2D drawing of from us**
- Additional machining services for rough pockets and precision pockets can also be made available
- Customized Mould Bases can be imported from **Many Places** against customers requirements
- Mould Base are manufactured using quality tooling made to perfection to meet customer quality requirements

Note:

TP: Top Plate

SP: Support Plate

BP: Bottom Plate

SB: Spacer Block

ERP: Ejector Retainer Plate

EP: Ejector Plate

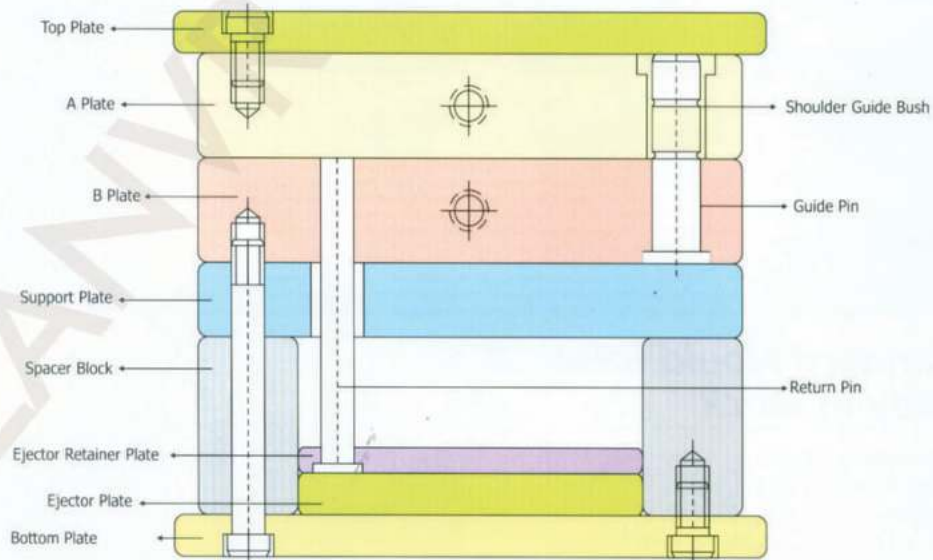

DRAWING OF STANDARD MOULD BASE READY IN STOCK



LANVR TOOLINGS

info@lanvrtoolings.com • Lokam@lanvrtoolings.com



Mould Sizes (mm)	Top Plate	A-plate Size	B-plate Size	Support Plate	Spacer Block	Ejector Retainer Plate	Ejector Plate	Bottom Plate
1515-40	200x 150x 20	150x 150x 40	150x 150x 40	150 x150 x30	150 x30 x60	150 x90 x13	150 x90 x15	200 x150 x20
1520-40	200x 200x 20	150x 200x 40	150x 200x 40	150 x200 x30	200 x30 x60	200 x90 x13	200 x90 x15	200 x200 x20
1520-50	200x 200x 20	150x 200x 50	150x 200x 50	150 x200 x30	200 x30 x60	200 x90 x13	200 x90 x15	200 x200 x20
2020-40	250x 200x 25	200x 200x 40	200x 200x 40	200x 200x 30	200x 40x 70	200x 120x 15	200x 120x 20	250x 200x 25
2020-50	250x 200x 25	200x 200x 50	200x 200x 50	200x 200x 30	200x 40x 70	200x 120x 15	200x 120x 20	250x 200x 25
2020-60	250x 200x 25	200x 200x 60	200x 200x 60	200x 200x 30	200x 40x 70	200x 120x 15	200x 120x 20	250x 200x 25
2025-40	250x 250x 25	200x 250x 40	200x 250x 40	200x 250x 30	250x 40x 70	250x 120x 15	250x 120x 20	250x 250x 25
2025-50	250x 250x 25	200x 250x 50	200x 250x 50	200x 250x 30	250x 40x 70	250x 120x 15	250x 120x 20	250x 250x 25
2025-60	250x 250x 25	200x 250x 60	200x 250x 60	200x 250x 30	250x 40x 70	250x 120x 15	250x 120x 20	250x 250x 25
2030-70	250x 300x 25	200x 300x 70	200x 300x 70	200x 300x 30	300x 40x 70	300x 120x 15	300x 120x 20	250x 300x 25
2525-40	300x 250x 25	250x 250x 40	250x 250x 40	250x 250x 35	250x 50x 80	250x 150x 15	250x 150x 20	300x 250x 25
2525-50	300x 250x 25	250x 250x 50	250x 250x 50	250x 250x 35	250x 50x 80	250x 150x 15	250x 150x 20	300x 250x 25
2525-60	300x 250x 25	250x 250x 60	250x 250x 60	250x 250x 35	250x 50x 80	250x 150x 15	250x 150x 20	300x 250x 25
2530-40	300x 300x 25	250x 300x 40	250x 300x 40	250x 300x 35	300x 50x 80	300x 150x 15	300x 150x 20	300x 300x 25
2530-50	300x 300x 25	250x 300x 50	250x 300x 50	250x 300x 35	300x 50x 80	300x 150x 15	300x 150x 20	300x 300x 25
2530-60	300x 300x 25	250x 300x 60	250x 300x 60	250x 300x 35	300x 50x 80	300x 150x 15	300x 150x 20	300x 300x 25
2535-60	300x 350x 25	250x 350x 60	250x 350x 60	250x 350x 35	350x 50x 80	350x 150x 15	350x 150x 20	300x 350x 25
3030-50	350x 300x 25	300x 300x 50	300x 300x 50	300x 300x 45	300x 60x 90	300x 180x 20	300x 180x 25	350x 300x 25
3030-60	350x 300x 25	300x 300x 60	300x 300x 60	300x 300x 45	300x 60x 90	300x 180x 20	300x 180x 25	350x 300x 25
3030-70	350x 300x 25	300x 300x 70	300x 300x 70	300x 300x 45	300x 60x 90	300x 180x 20	300x 180x 25	350x 300x 25
3035-50	350x 350x 25	300x 350x 50	300x 350x 50	300x 350x 45	350x 60x 90	350x 180x 20	350x 180x 25	350x 350x 25
3035-60	350x 350x 25	300x 350x 60	300x 350x 60	300x 350x 45	350x 60x 90	350x 180x 20	350x 180x 25	350x 350x 25
3535-60	400x 350x 30	350x 350x 60	350x 350x 60	350x 350x 45	350x 65x 100	350x 220x 20	350x 220x 25	400x 350x 30
3535-70	400x 350x 30	350x 350x 70	350x 350x 70	350x 350x 45	350x 65x 100	350x 220x 20	350x 220x 25	400x 350x 30
3540-70	400x 400x 30	350x 400x 70	350x 400x 70	350x 400x 45	400x 65x 100	400x 220x 20	400x 220x 25	400x 400x 30
4040-80	450x 400x 30	400x 400x 80	400x 400x 80	400x 400x 50	400x 70x 120	400x 260x 25	400x 260x 30	450x 400x 30



**Section:
MOULD ACCESSORIES
& MOULD BASE**



EJECTION SYSTEMS



Ejector Pins Type A (DIN/JIS)



Ejector Pins Type C (DIN)



Blade Ejector Pins (DIN)



Ejector Sleeves (DIN)



Drawings for Customized Requirements



Air Ejector Pin Type A



Air Ejector Pin Type B



Air Ejector Pin Type C



Air Ejector Pin Type D



Air Vents



Plate Accelerator



Spring Core



Core Unit Fixed Type



Lifter Rod Guide Unit



Two Stage Ejector Pin



**SLIDE RETAINER, LATCHES
& PARTING LOCK**



Spring Plunger Screw Type



Spring Plunger Allen Key Type



Slide Retainer Type A



Slide Retainer Type B



Slide Retainer Type C



Slide Retainer Type D



Parting Lock



Latches Type A



Latches Type B



Latches Type C



Latches Type D - Short Length



Latches Type D - Long Length



Latches Type E



Latches Type F



**MOULD ALIGNMENT
PRODUCTS**



Guide Pin Type A



Guide Pin Type B



Guide Bush Type A



Guide Bush Type B



Oilless Bush Type A



Oilless Bush Type B



Oilless Bush Type C



Oilless Bush Type D



Oilless Plates



Oilless Guide Rails



Taper Interlock Type A



Taper Interlock Type B



Taper Block Set



Straight Block Set



Interlock Type T



Square Block Set



MOULD DATE INDICATORS

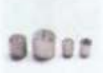

Single Piece Mould Date Indicator



Recycling Insert



Center Replaceable Date Indicator Spring Loaded Long Length



Center Replaceable Date Indicator Spring Loaded Short Length



Center Replaceable Date Indicator Ball Loaded



Center Replaceable Date Indicator Screw Type



Center Replaceable Date Indicator Bottom Ball Loaded



Double Date Indicator



Combined date Indicator



Mini Date Indicator



COOLING PRODUCTS



Cooling Plugs O-Ring Type



Cooling Plugs Threaded Type



Cooling Baffles Straight Type



Cooling Baffles Spiral type



Cooling System Type A



Cooling System Type B



Heat Insulation Products



Heat Pipes



Sprue Bush



STANDARD MOULD BASE



Mould Counter



Mould Sprays



**POLISHING
& FINISHING TOOLS**



**METRIC HEXAGON
SOCKET HEAD
SHOULDER SCREW**



**RECTANGULAR WIRE
DIE SPRINGS
AS PER ISO-10243**



Light Green Color Extra Light Load



Green Color Light Load



Blue Color Medium load



Red Color Heavy Load



Yellow Color Extra Heavy Load



**RECTANGULAR WIRE
DIE SPRINGS
AS PER JIS Standard**



Yellow Color Lightest Load



Blue Color Light Load



Red Color Medium Load



Green Color Heavy Load



Brown Color Ultra Heavy Load



Gray Color Hyper Heavy load



Light Blue Color Super High Deflection



White Color High Deflection



Purple Color Middle Deflection



**Section:
PRESS TOOL ACCESSORIES**



Piercing Punches



Polyurethane Elastomers



Ball Cage



Brass EDM Wire



V-36



V-72



V-45



V-3390



V-6204



Code	Description
V-36	Mould Release
V-72	Mould Protector
V-45	Mould Maintenance & Multi Purpose
V-3390	Mould Ejector & Guide Pin Lubricant
V-6204	Bright Zinc

Available Ex-Stock

Ordering Example: Code - Quantity
V-36 - 5 pieces

Mould Sprays



Mold Alignments Products

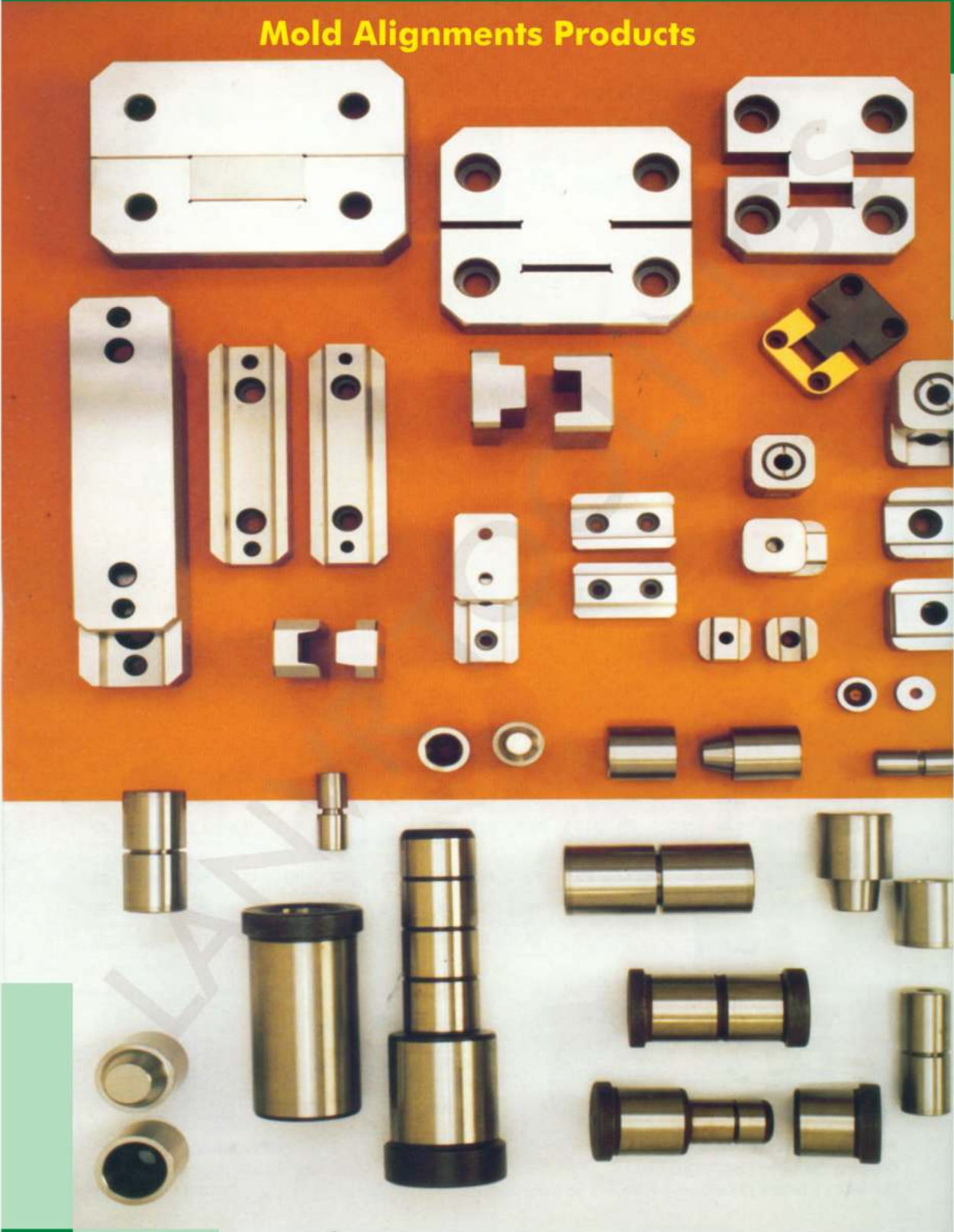



DATE INDICATORS





Mold Cooling Products





Air Ejector Pin and Air Vent





Thermal protection solutions for tool & mould making

During plastic molding process precious energy is lost by means of heat reflection and heat convection. Heat insulation sheet has been developed to reduce these losses. Available in different grades for temperatures ranging from 200°C to 500°C

Heat Insulation products



Using Insulations in injection moulding, compression moulding and die cast tools will achieve:

- Compression and temperature resistant separation between hot tool and machine
- Evenly distributed temperature and reproducible flow characteristics
- Improved product quality specifically in multi cavity moulds
- reduced pre heating time and lower energy loss due to radiation
- fast mould readiness for production
- Higher process safety and lower manufacturing cost

Hot Runner Insulations:

- High temperature resistance for continuous use
 - Insulation for small spaces
 - Excellent electrical insulation properties
-
- Available in thickness of 3 mm to 30 mm
 - Size upto 1000 mm x 2000 mm long
 - Easily machinable as per moulds requirements
 - High temperature resistance
 - Good insulation values
 - Precisely controls temperature for better product quality
 - Low compression set & excellent thermal conductivity to save energy cost

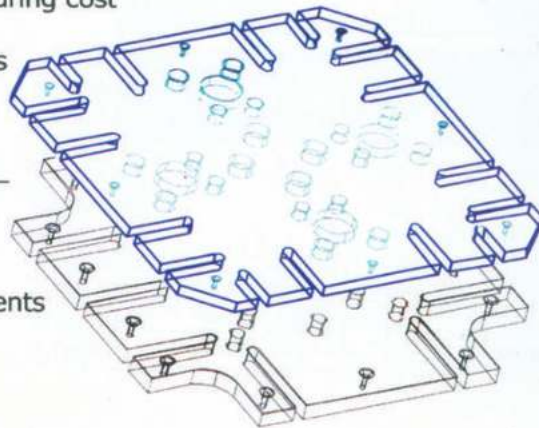

customized heat insulation sheets / rings and various shapes are available upon customers request



Slide Retainer latches & Parting Locks

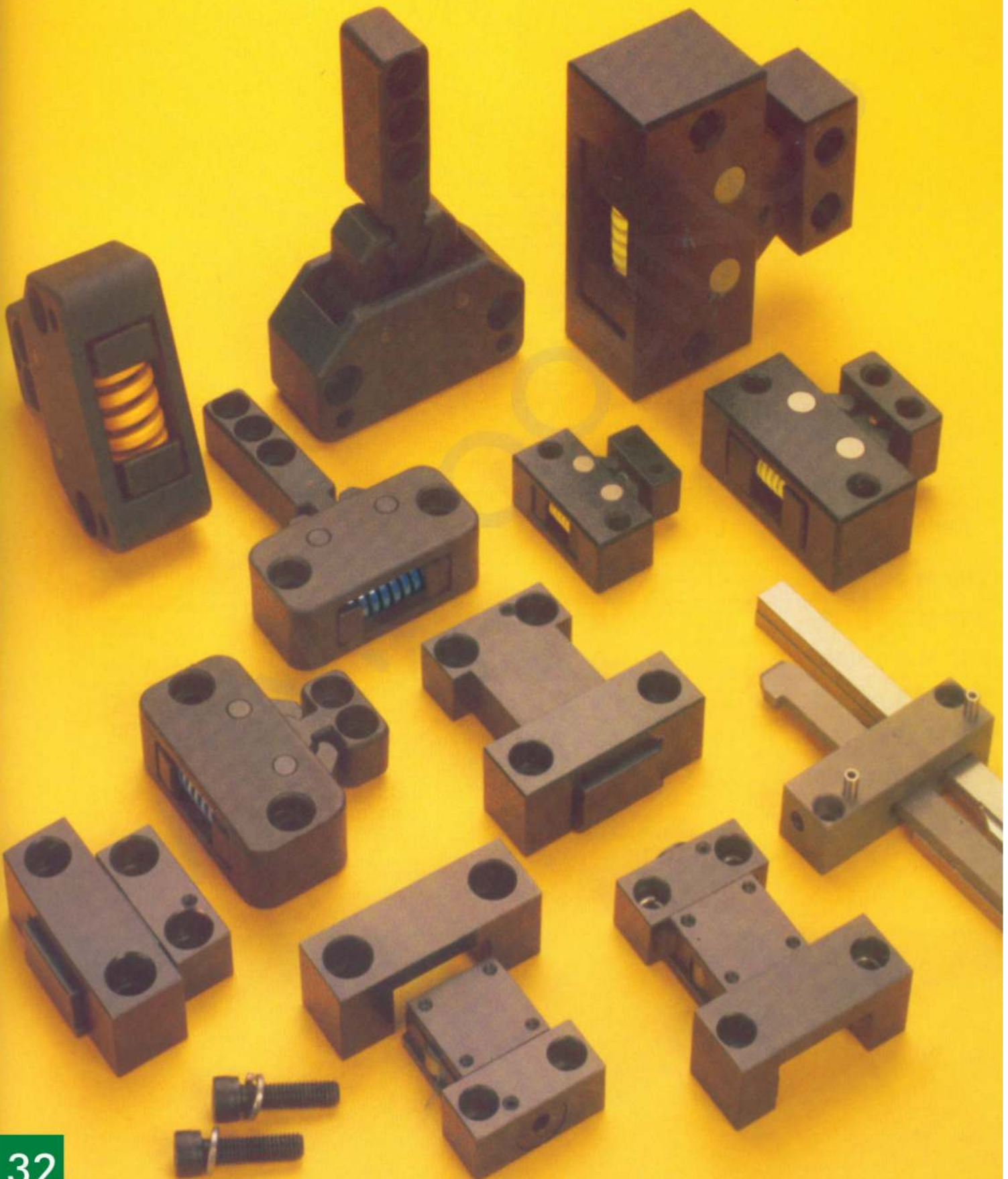



Latches for three plate mould (Type B)

Raw material:
SCM-21
Hardness:
56-60 HRC

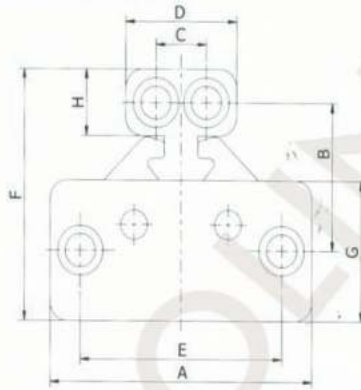

Code	Type	A	B	C	D	E	F	G	H	force (kg)	screw hole
VLB-001	Medium	78	40	15	33	60	68	38	18	500 kg	M8
VLB-002	Heavy	91	58	17	37	72	93	51	30	900 kg	M10



Available Ex-stock

Ordering Example: Code = Quantity

VLB-002 - 8 pieces (1 piece = 1 Male + 1 Female)

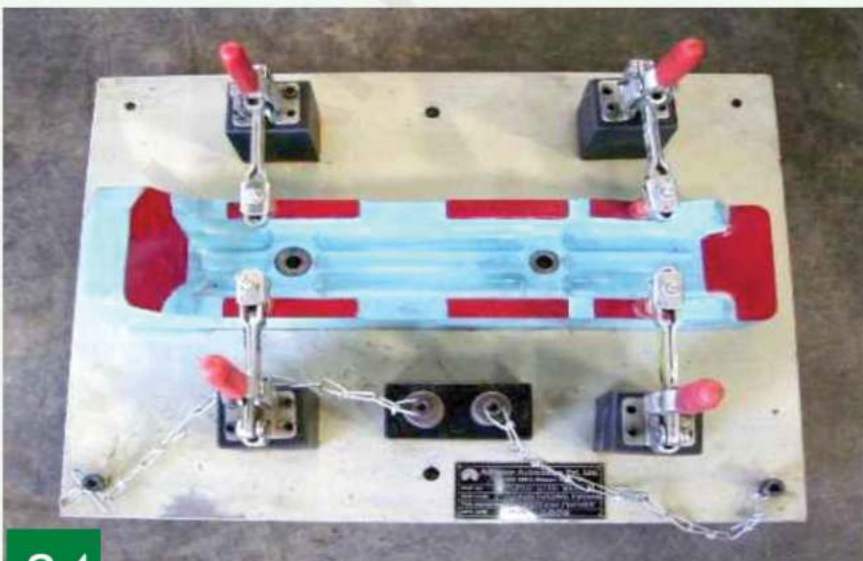
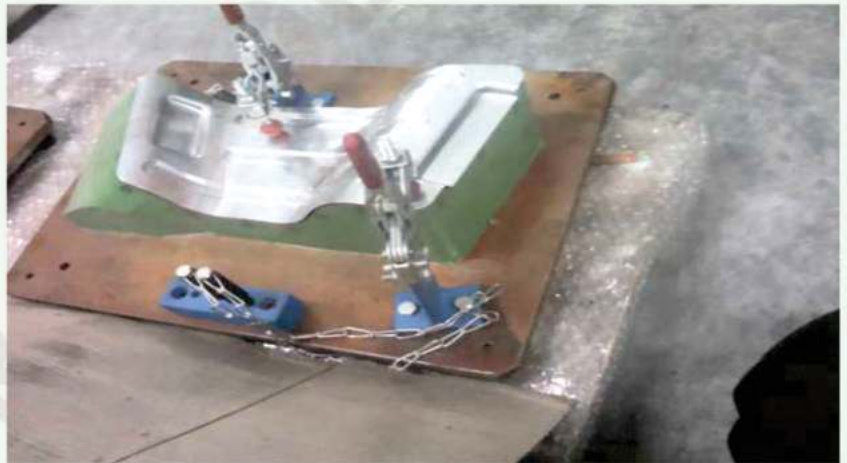
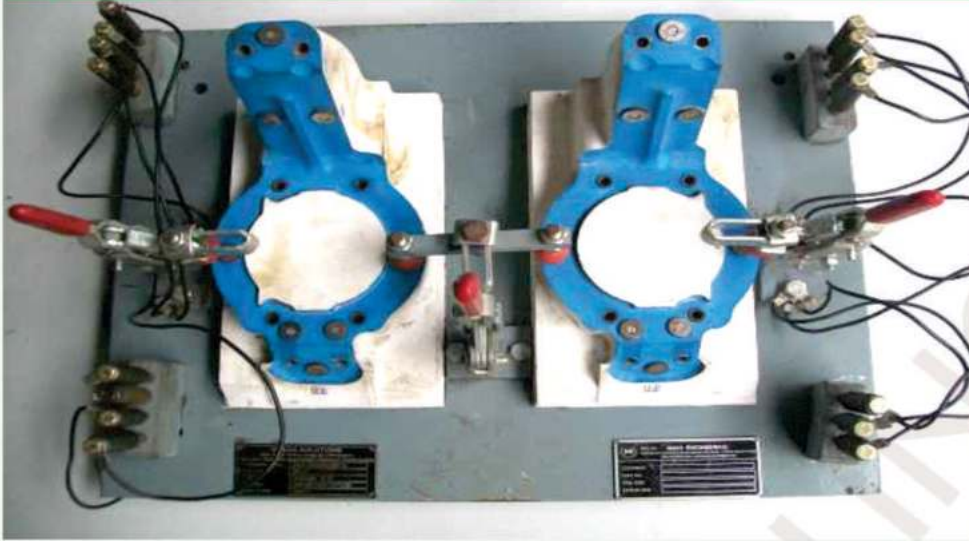

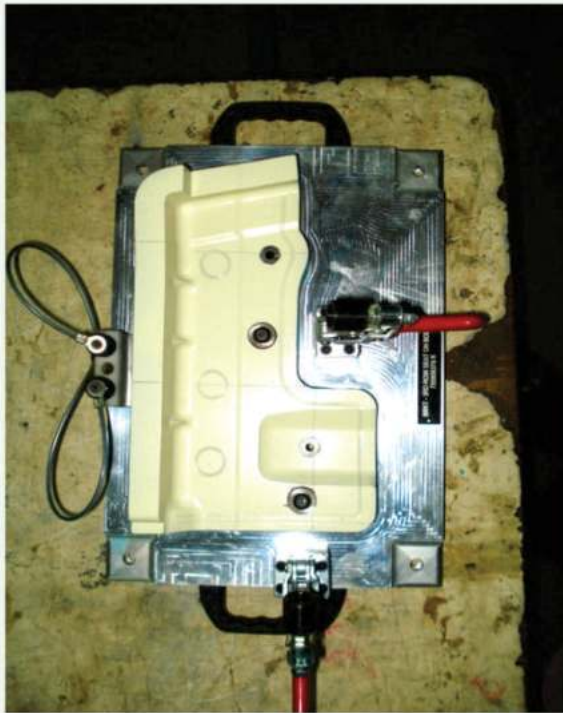

Tube fixture for Cooper Standard

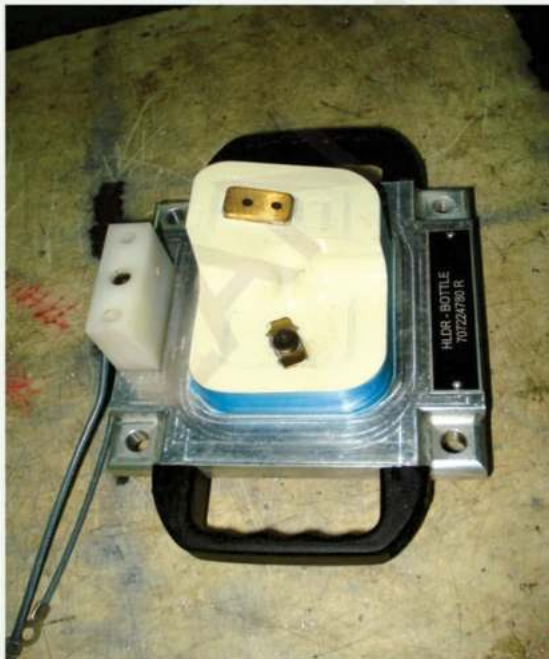



Checking Fixture



WWW.LANVRTOOLINGS.COM

Address:
LANVR INDO GERMAN
TOOLING INDUSTRY
4-64/1, Kesarapalli,
Gannavaram Mandal,
Vijayawada,
Andhra Pradesh-521102.
INDIA

Address:
LANVR INDO GERMAN
TOOLING INDUSTRY
5/5/35/90A, Plot no9,
Prasanth Nagar, Kukatpally,
Hyderabad, Rangareddy,
Telangana, 500072,
INDIA

**INDIA
SAUDI ARABIA
UAE**

Email :
info@lanvrtoolings.com
Lokam@lanvrtoolings.com
lanvrindogermantoolings@gmail.com

Mobile:
India : +91 9585580345
+91 8885 504 504
Saudi Arabia : + 966 573307498